

MDE Series
Molding Power Inductors
Size 0412

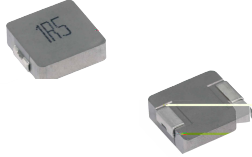

FEATURES

-
-
-
-
-
-
-
-
-
-

°C

APPLICATION

-
-
-
-
-
-
-
-
-
-

Dimensions: [mm]

Land Pattern: [mm]

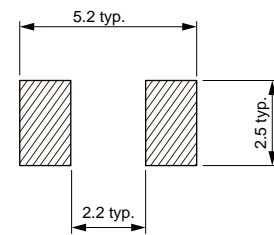
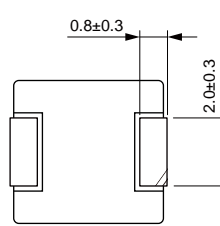
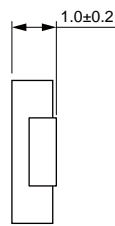
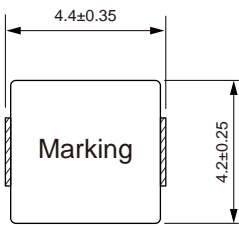

Electrical Properties:

| | (μ H) | | (m Ω) | Saturation | |
|--|------------|--|---------------|------------|--|
| | | | | | |
| | | | | | |
| | | | | | |
| | | | | | |
| | | | | | |
| | | | | | |
| | | | | | |
| | | | | | |
| | | | | | |

Saturation Current will cause L to drop approximately 30%

Temperature Rise Current: The actual value of DC current when the temperature rise is $\Delta T=40^{\circ}\text{C}$

Typical Electrical Characteristics:

Inductance vs DC Current Characteristics:

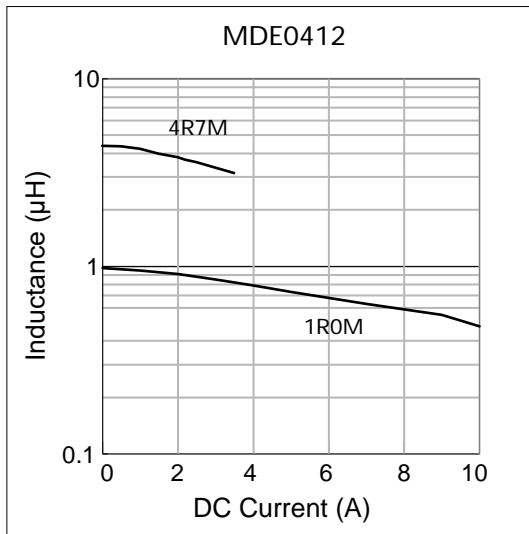

Temperature Rise vs DC Current Characteristics:

