

# BCMA Series

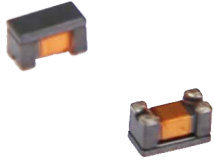

## FEATURES

- 
- ters f
- °C
- 
- 

## APPLICATION

- interf ST, USB2.0, IDB-1394, et

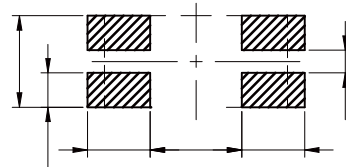
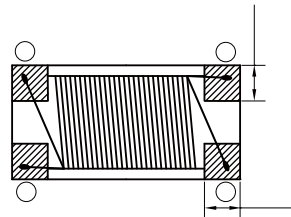
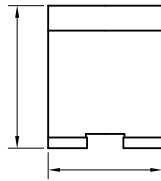
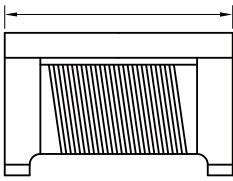

Part No	Impedance @ 100 MHz ( )	Tolerance	Temperature Rise Current Max. (mA)	DC Resistance Max. ( )	Rated Voltage (V)
	90	±20%	370	0.30	50
	160	±20%	340	0.40	50
	260	±20%	310	0.50	50
	600	±20%	260	0.80	50
	1000	±20%	230	1.00	50
	2200	±20%	200	1.20	50



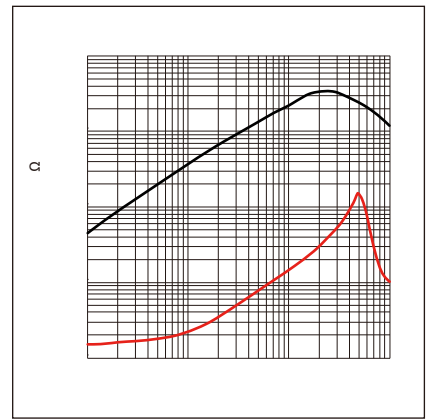
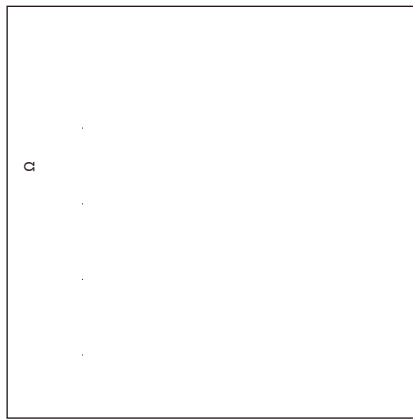
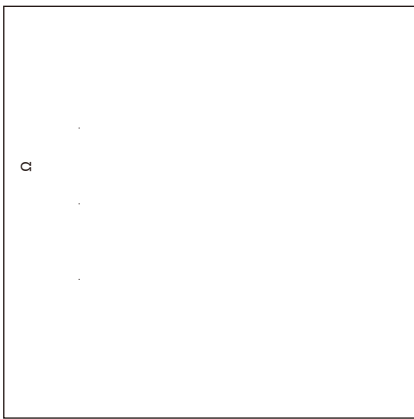
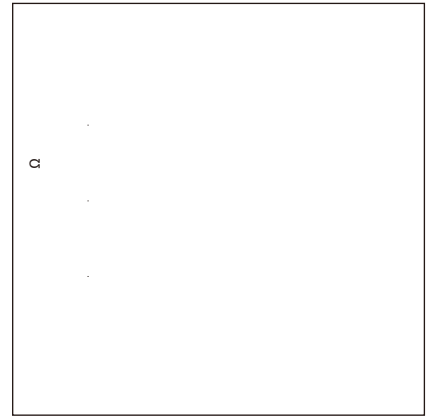
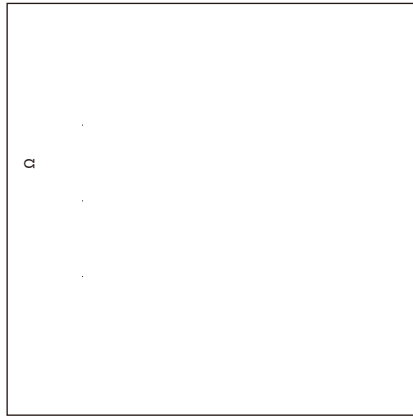
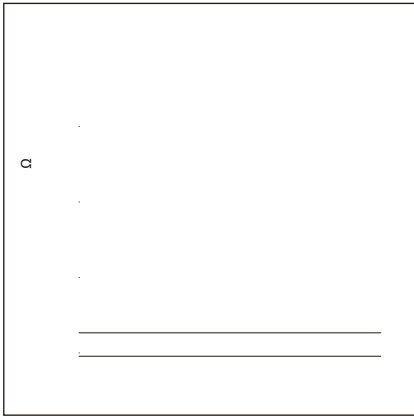

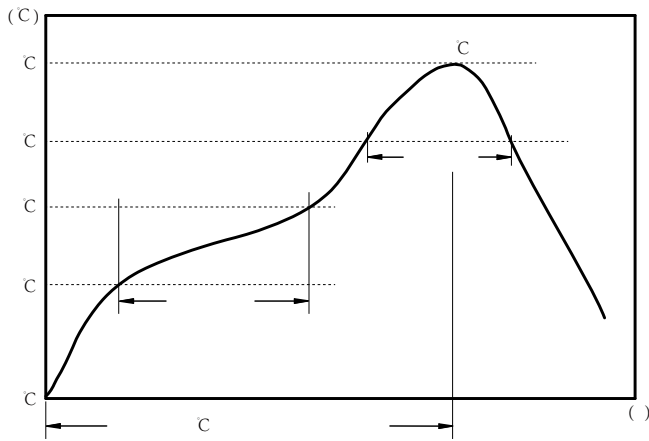

c  
c  
c

:



BCMA3216	1.88 typ.	3.50 typ.	1.5±0.1	4.0±0.1	4.0±0.1	8.0±0.3	2.1 typ.	1.75±0.1	0.20±0.1

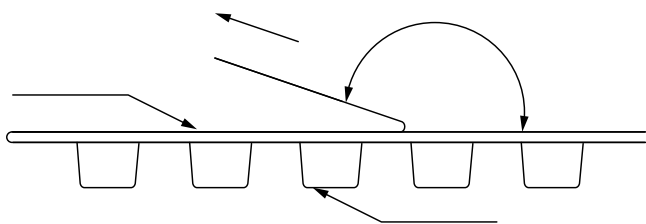

The peel force of top cover tape shall be between 0.1 to 1.0 N

:

